

Wärmetauscher AUSTRIA

POWER **S**OLAR

THERMISCHE HÖCHSTLEISTUNG MIT DER KRAFT VON EXPERTEN

www.power-solar.at / office@power-solar.at

Tel.: +43 (0) 7229-81 800



PRODUCT RANGE DN 65 - 2" 1/2

Standard or Customized

Wärmetauscher AUSTRIA

POWER **SOLAR**

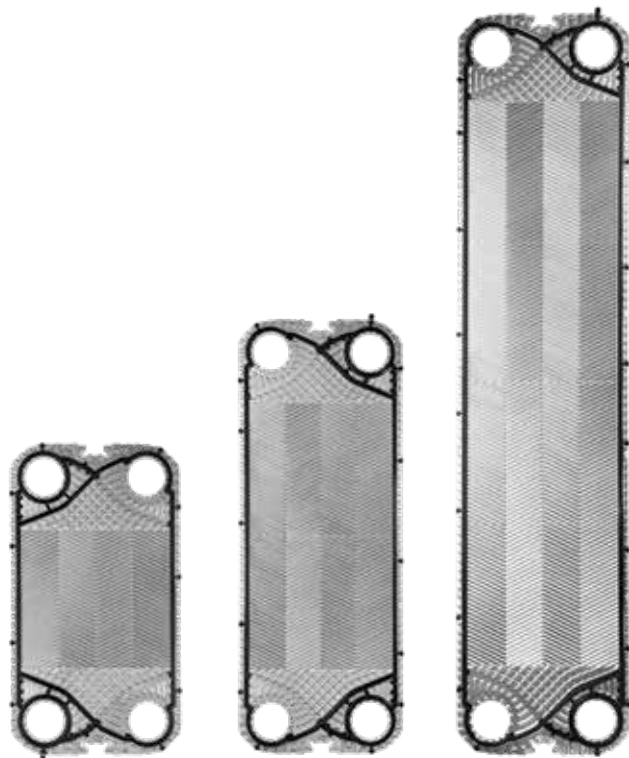

Product Range	P110+			P210+			P410+		
Exchange area [m ²]	0,118			0,21			0,395		
Width [mm]	320								
Height [mm]	584			848			1375		
Connections diameter	DN65 2"1/2								
Channel capacity [l]	0,335			0,52			0,891		
Tightening quote [mm]*	3								
Plate weight (with gasket) [Kg]*	0,722			1,058			1,738		
Corrugation angle	A/B								
Max. water flowrate [m ³ /h]	80								
PS=> Max working pressure [bar]	10	16	25	10	16	25	10	16	25

DN32	DN50	DN65	DN80	DN100	DN150	DN200
------	------	-------------	------	-------	-------	-------

Tutti i dati e disegni nel presente documento possono subire variazioni senza preavviso e non sono vincolanti per il produttore.

All data and drawings herewith described can be changed without prior notice and are not binding for the manufacturer.

FRAMES DIMENSIONS

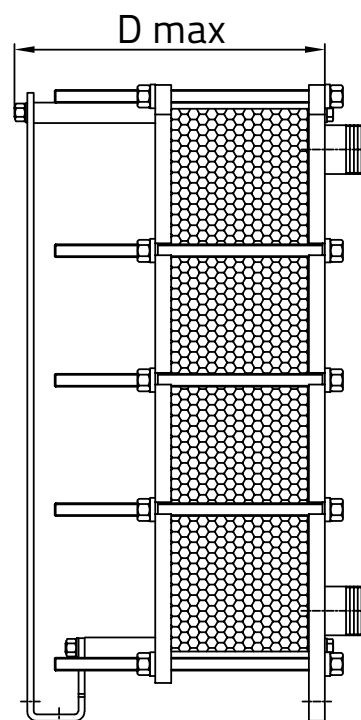
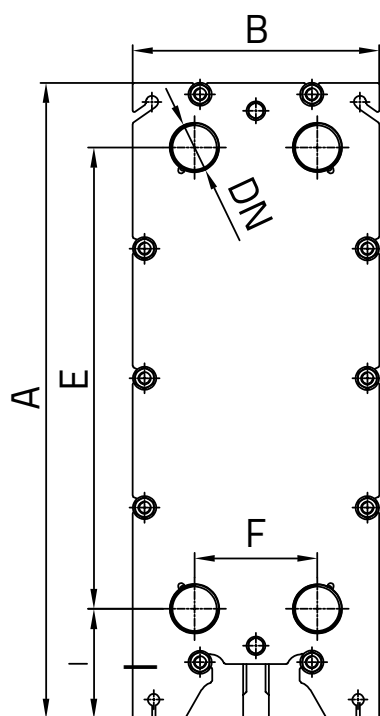

	S110+				S210+				S410+				
A	729 / 760				992 / 1024				1551				
B	385 / 400				385 / 400				400				
E	456				720				1247				
F	192				192				192				
I	171				171				171				
Np max	41	71	101	151	41	71	101	151	41	71	101	151	251
D max	355	495	635	865	355	495	635	865	485	485	625	855	1315
DN	DN65 2"1/2												

Connections dimensions (C)

J-J	88	88	-
M-M	93	93	-
J-M	93	93	-
R-R	88	88	-
J-R	88	88	-
Y-Y	88	88	-
A-A B-B U-U	36	28 / 36	36
C-C E-E V-V	36	28 / 36	36

Tutte le dimensioni sono in mm - Np = numero di piastre. All dimensions are in mm - Np = number of plates.

GAS MALE THREADED CONNECTIONS

J/M

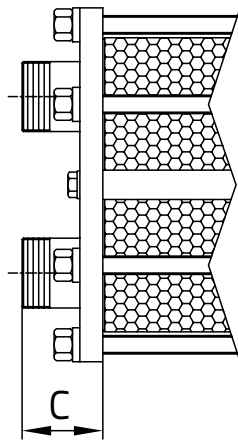

ISO 2852 CLAMP CONNECTIONS

R

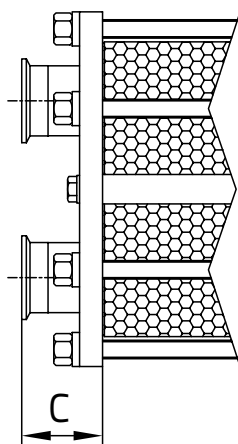

GROOVED PIPE CONNECTIONS

Y

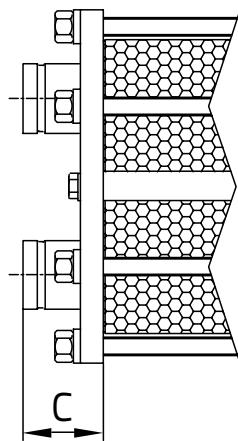

ISO STUDDED PORTS

A/B/U

ANSI STUDDED PORTS

C/E/V

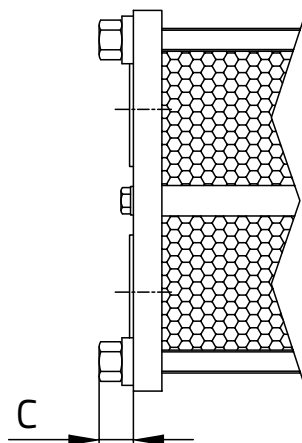

GROUND ANCHORING (G)

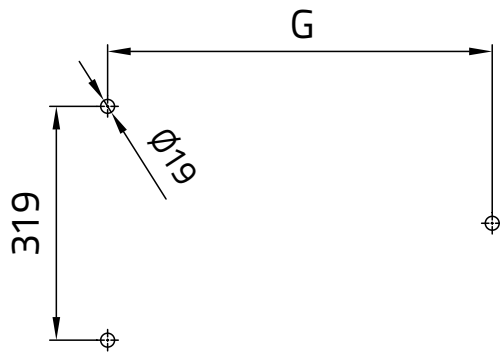

PS 10

PS 16

PS 25

S110+/S210+

Max 41p	385	390	395
Max 71p	525	530	535
Max 101p	665	670	675
Max 151p	895	900	905

S410+

Max 41p	583	583	588
Max 71p	583	583	588
Max 101p	723	723	728
Max 151p	953	953	958
Max 251p	1413	1413	1418

Tutte le dimensioni sono in mm. All dimensions are in mm.

MATERIALS

	S110+	S210+	S410+
AISI 304	●	●	●
AISI 316L	●	●	●
254 SMO	●	●	●
Titanio / Titanium	●	●	●
NBR	●	●	●
EPDM Prx.	●	●	●
FPM	●	●	●
HNBR	●	●	●
Acciaio Carbonio / Carbon steel	●	●	●
Acciaio inox / Stainless steel		●	
J (AISI316)	●	●	
M (PP)	●	●	
R (Clamp)	●	●	
Y (Victaulic)	●	●	
A / C (Rubber lined)		●	●
B / E (AISI316L lined)	PS 25	●	
U / V (Unlined)	PS 25	●	●

Materiali guarnizioni e temperature massime Gaskets material maximum temperatures

NBR	-20 °C	110 °C
EPDM Prx.	-20 °C	160 °C
FPM	-20 °C	200 °C
HNBR	-20 °C	160 °C

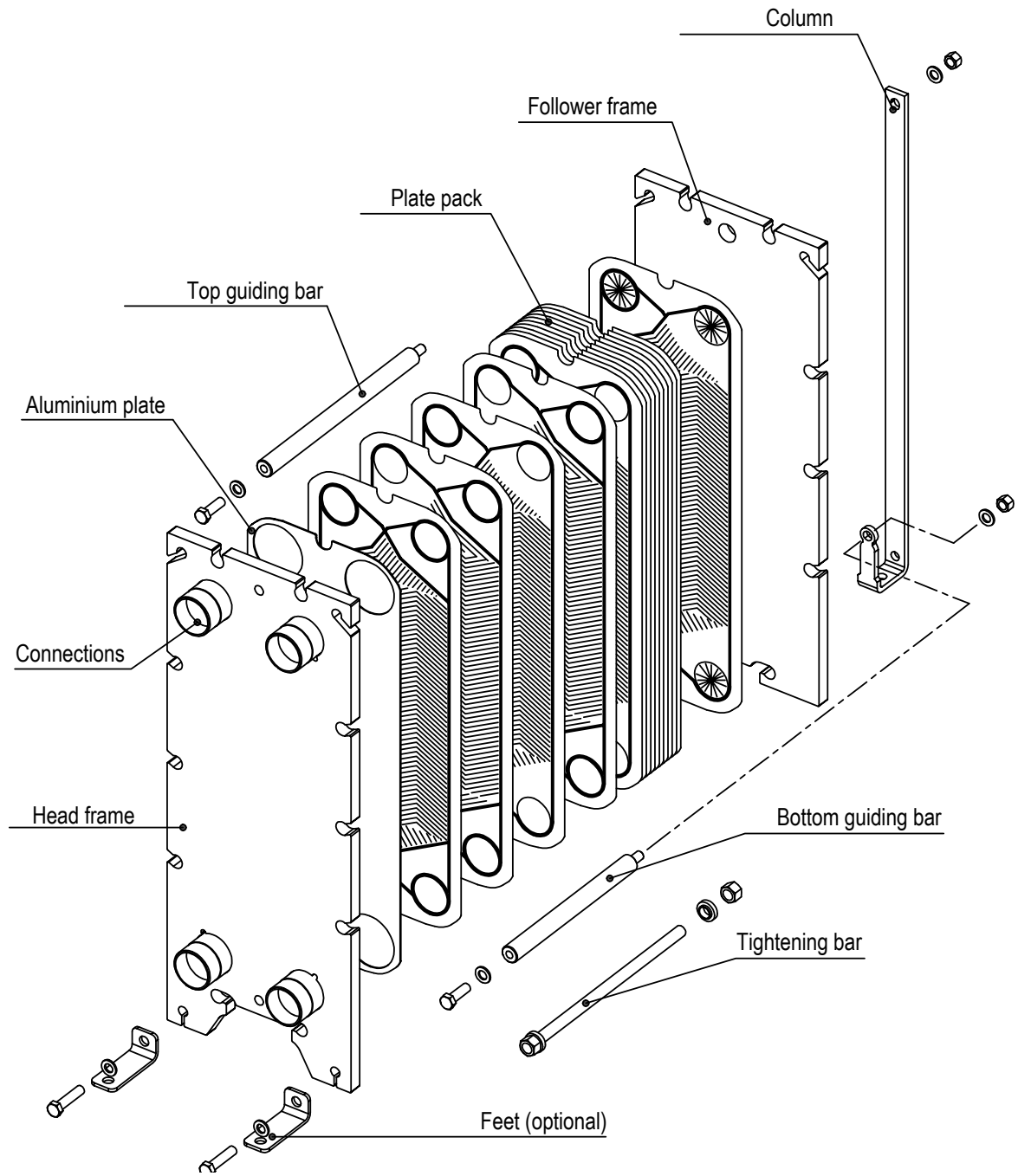

APPROVALS



• ACS
Attestation de Conformité Sanitaire

• OHSAS 18001
Occupational Health and Safety

• ISO EN 9001:2015
European Quality Certificates

• PED 2014/68/UE
Pressure Equipment Directive
Module B,D1 & D (up to Risk Cat. IV)



• WRAS
EPDMprx gasket compound approved



• ISO 14001
Environmental Management



Wärmetauscher AUSTRIA

POWER SOLAR

THERMISCHE HÖCHSTLEISTUNG MIT DER KRAFT VON EXPERTEN

www.power-solar.at / office@power-solar.at

Tel.: +43 (0) 7229-81 800